



Download Installation Guide:  
Installation Guide is available in:  
English, German, Spanish, French,  
Italian, Dutch, Portuguese, Swedish,  
Danish, Norwegian, Polish, Czech,  
Hungarian, Russian, Turkish



Download Installation Guide:  
Installation Guide is available in:  
English, German, Spanish, French,  
Italian, Dutch, Portuguese, Swedish,  
Danish, Norwegian, Polish, Czech,  
Hungarian, Russian, Turkish

[www.mt.com/ind-downloads-multimount](http://www.mt.com/ind-downloads-multimount)

[www.mt.com/ind-downloads-powermount](http://www.mt.com/ind-downloads-powermount)

### Before You Begin

1»



If weigh module is used in a dynamic situation, for example, vibration, mixing, ETC, optional stabilizer must be applied for safety.

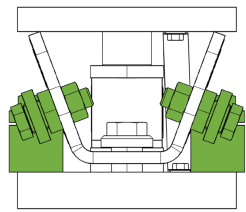

Optional stabilizer  
(One or two per weigh module)

NYLOK patch

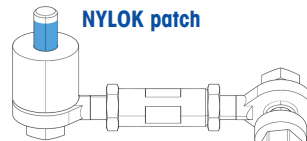

Pre-assembled  
SS304 & CS stabilizers

Thread locking glue

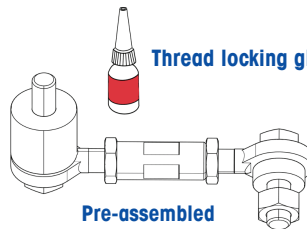

Pre-assembled  
SS316 stabilizer

### Plan Your Layout

2»

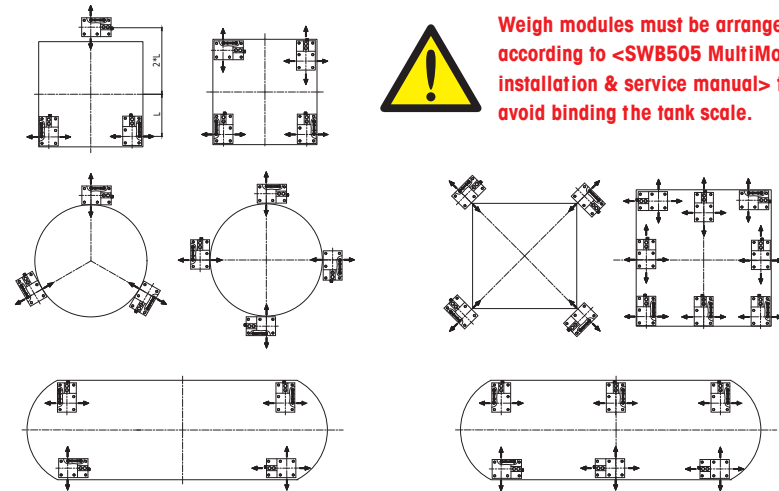

Weigh modules must be arranged according to <SWB505 MultiMount™ installation & service manual> to avoid binding the tank scale.

### Activate Weigh Modules

3»

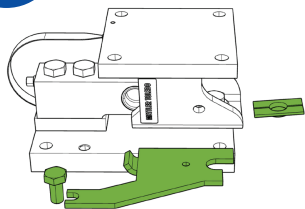

Disassemble  
SafeLock™ spacer &  
SafeLock™ centering  
washer

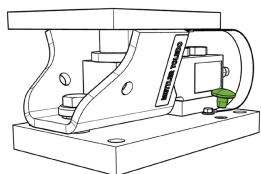

Remove the plastic  
plug from the hold in  
the base plate

### Pre-glue Stabilizer

4»



Add thread locking  
glue only for SS316  
version stabilizer.

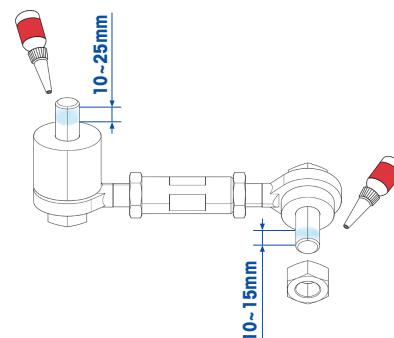

### Assemble the Stabilizer

5»



Tighten the bolts  
Size 1: M8, 20Nm  
Size 2: M10, 35Nm  
Size 3: M12, 60Nm

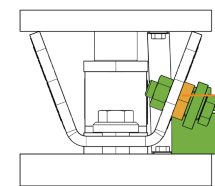

Confirm the nut  
installed outside  
the U-plate



Check and adjust

Step 1: Loosen the jam nuts  
Step 2: Turn the center coupler  
Step 3: Retighten the jam nuts

Note: The stabilizer has been pre-adjusted to the correct length for easy installation. Adjust only when it is necessary.

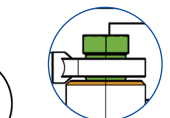
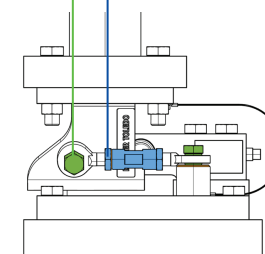

Chamfer on standoff  
4.4t (10k) model